

Information about the Groundwater Field Demonstration

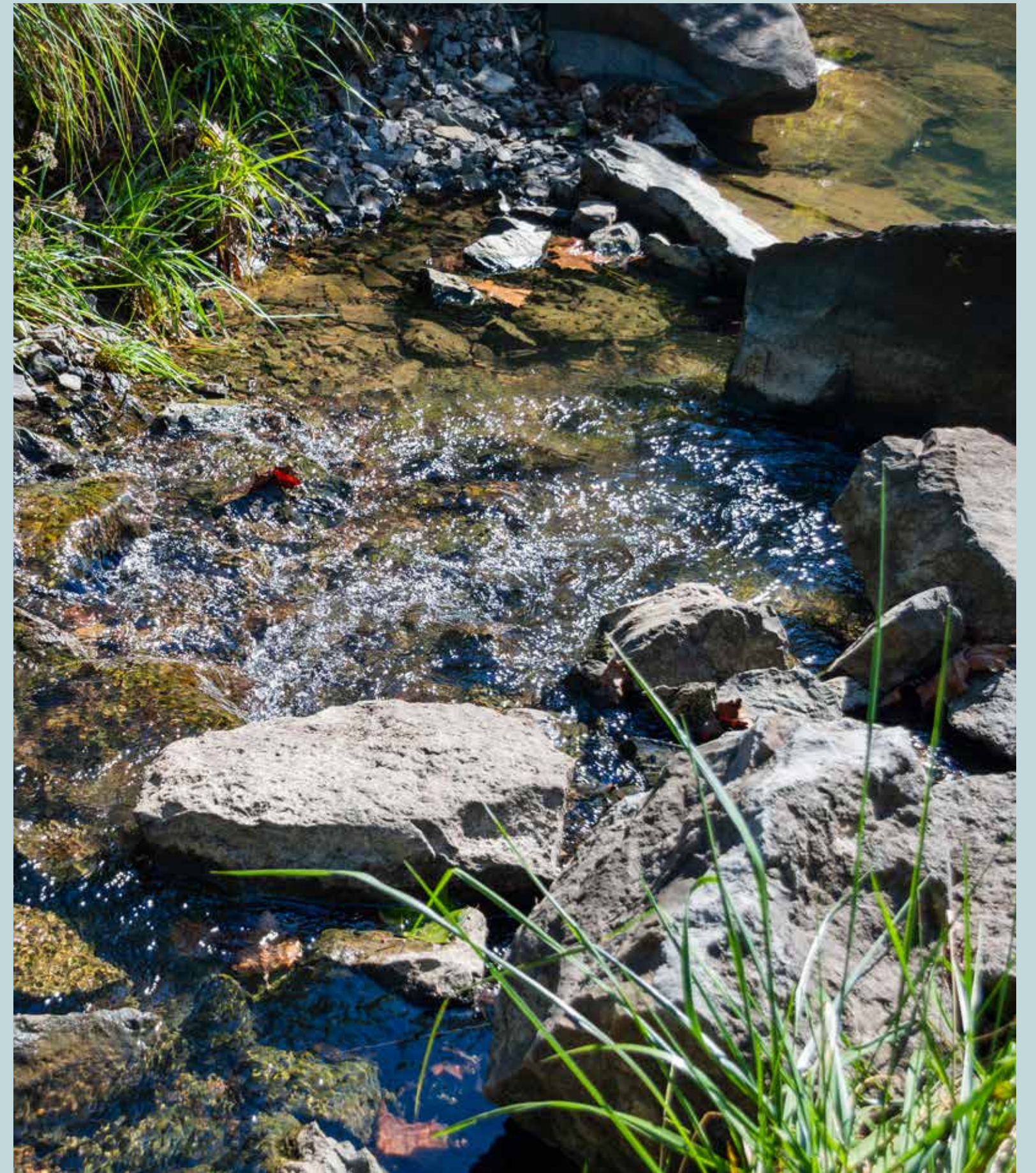

Sample Locations at EMDF

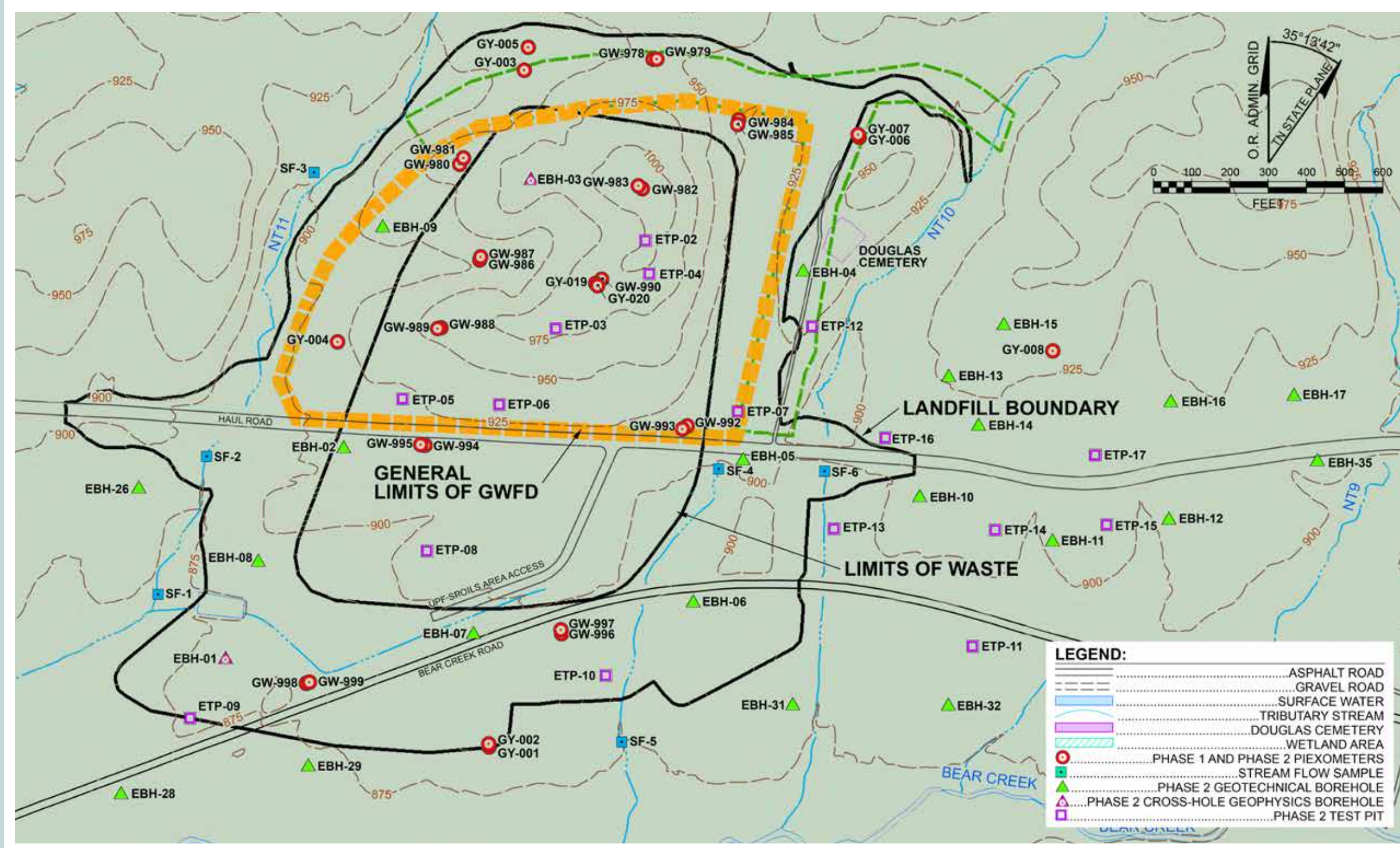

Key Design Features:

- Durable, low maintenance cover system to prevent rainfall infiltration
- Monitoring locations accessible via graveled roadways on cover system
- Demonstration period is 2 wet seasons from completion of cover
- Final design starts after the end of the first year
- Ditches and detention ponds sized for fully built-out landfill
- Seismic design requirements same as landfill



U.S. DEPARTMENT OF
ENERGY



Oak Ridge Office of Environmental Management